

DESCRIPTION OF HOOD

- A. Aesthetic cap
- B. Support bracket with cables and fixing brackets
- D. Adjustment screw
- E. Cover
- D. Connection box
- G. Cable clamp
- H. Interconnection cable
- J. Hood unit (motor + lights assembly)
- K. Control rod
- L. Halogen bulb
- M. Filter holder frame
- N. Carbon filter (already fitted)
- O. Grease filter (already fitted)
- P. Filter holder frame
- Q. Fixing screws
- R. Lighting unit of side lamps
- Y. Assembly template

Warning! The control rod is supplied with the appliance and must be installed last, before connecting the hood to the power supply.

Insert the control rod in the special seat (see the diagrams on the first pages of this handbook - with release, compulsory coupling direction).

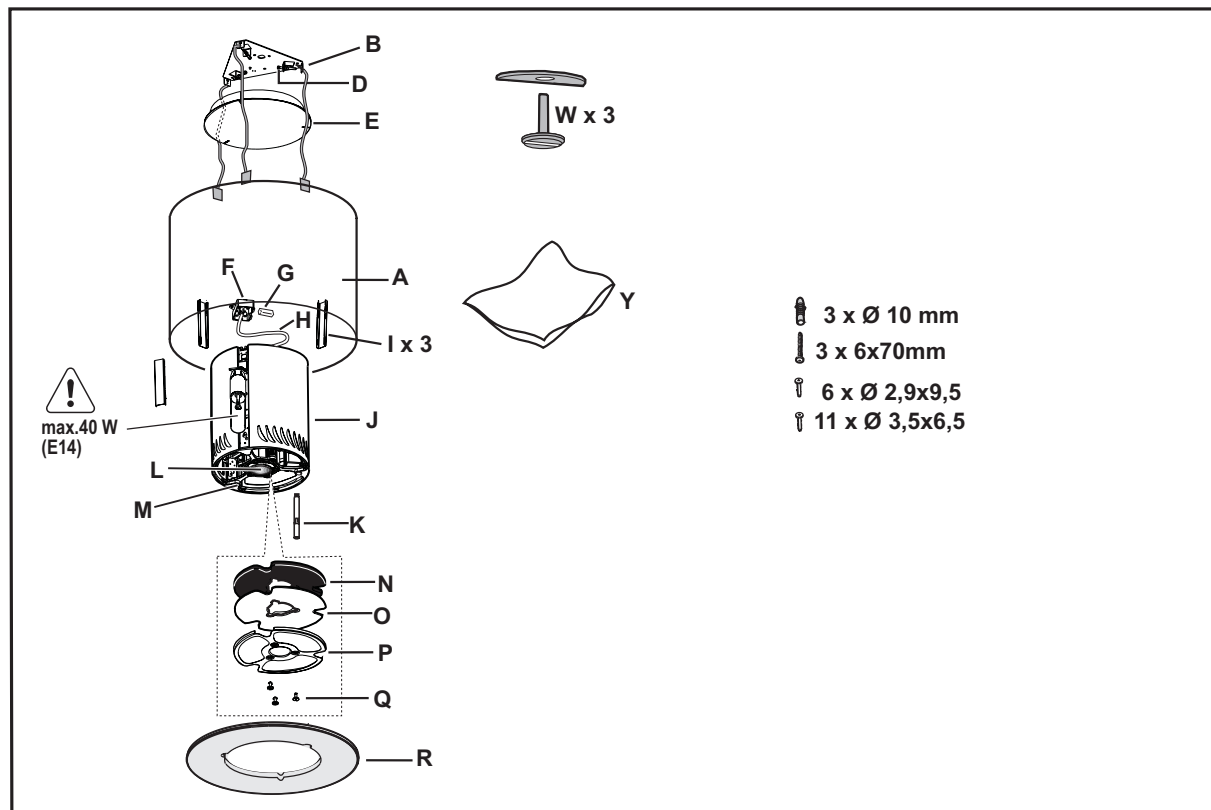

PRODUCT SHEET

Control panel

Preliminary information for correct use of the hood:

Use the fastest speed setting for particularly concentrated steam and fumes. It is advisable to switch the hood on 5 minutes before starting to cook and leave it running for another 15 minutes at the end of cooking.

The hood is equipped with a “**TOUCH SENSOR**” device able to determine when the control rod is touched by the user, thus enabling control of lights and speeds. For this purpose, carefully read the following instructions.

Automatic switching on function

The hood is equipped with a temperature sensor that activates the motor at extraction speed (power) 1 when the ambient temperature in the area surrounding the hood exceeds 70°C.

In any case, the user can still switch off or change the extraction speed (power) (refer to section “**Extraction speed (power) control**”).

Extraction speed (power) control

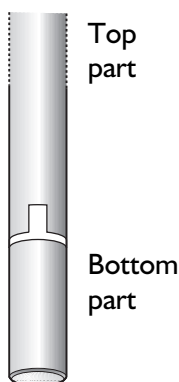

Extraction speed (power) selection is cyclic according to the speed sequence

→ stand-by - 1 → 2 → 3 → 4 →

therefore every time the **TOP PART** of the control rod is touched the extraction speed (power) increases by one level and switches off (stand-by) if the rod is touched again when the hood is on extraction speed (power) 4.

Note: Extraction speed (power) 4 remains on for 5 minutes, after which the extraction motor switches to speed 2.

By touching the rod again the extraction motor switches off (Stand-by).

The hood can also be switched off (stand-by) when the hood is on any speed, by touching the **TOP PART** of the control rod for more than 3 seconds.

The hood extraction speed (power) can be determined, since the rod is provided with a LED that changes colour according to the extraction speed (power) as follows:

Hood on stand-by: LED OFF

extraction speed (power) 1 - GREEN LED

extraction speed (power) 2 - ORANGE (amber) LED

extraction speed (power) 3 - RED LED

extraction speed (power) 4 - RED LED (FLASHING)

Grease filter cleaning required: GREEN LED flashing (read the relevant instructions in “Reset and configuration of filter saturation signalling”)

Carbon filter cleaning or changing required: ORANGE (amber) LED flashing (read the relevant instructions in “Reset and configuration of filter saturation signalling”)

Control of middle light

The middle light can be switched on or off by BRIEFLY touching the **BOTTOM PART** of the control rod.

Control of side lights (when provided)

The side lights can be switched on or off by PROLONGED touching of the **BOTTOM PART** of the control rod.

As well as switching on and off, PROLONGED TOUCHING allows adjustment of brightness of the lamps.

Note: The switching on and off (and adjustment) functions alternate.

Reset and configuration of filter saturation signalling

Switch the hood on at any speed (refer to section “Extraction speed (power) control”)

Reset of grease filter saturation signalling (GREEN LED FLASHING on control rod)

Firstly carry out filter maintenance as described in the relevant section.

Touch the **TOP PART** of the control rod for more than 3 seconds, the LED will stop flashing to indicate that signalling has been reset, and the hood switches off.

Reset of carbon filter saturation signalling (ORANGE (amber) LED FLASHING)

Firstly carry out filter maintenance as described in the relevant section.

Touch the **TOP PART** of the control rod for more than 3 seconds, the LED will stop flashing to indicate that signalling has been reset, and the hood switches off.

Deactivation of carbon filter saturation signalling (for particular applications)

Switch off the hood (refer to section “Extraction speed (power) control”)

Touch the **TOP PART** of the control rod for more than 5 seconds, the LED will flash GREEN (amber) indicating deactivation of carbon filter saturation signalling.

To reactivate carbon filter saturation signalling, repeat the operation, and the LED will flash ORANGE.

Maintenance

ALWAYS disconnect the hood from the mains before performing maintenance.

Grease filter

It must be cleaned once a month (or when the filter saturation system - if present on model in question - indicates cleaning is necessary) with a mild detergent, by hand or in a dishwasher using a low temperature, short wash cycle. Cleaning in a dishwasher may cause discolouring of the grease filter, but its filtering efficiency is unaffected.

Carbon filter

Retains any unpleasant odours produced during cooking. The carbon filter can be washed every two months (or when the filter saturation system - if present on model in question - indicates cleaning is necessary) in hot water and with suitable detergents or in a dishwasher at 65°C (when cleaning in a dishwasher, do a complete wash cycle without any dishes). Remove excess water without damaging the filter, then place in the oven at 100°C for 10 minutes to dry it completely. Replace the wadding every 3 years or whenever it is seen to be damaged.

Removing the filters

The metal grease filter and the carbon filter are installed coupled at the bottom (extraction area).

To remove or refit them, proceed as follows:

Fig. 11

a + c. turn the three screws 1/4 turn.

b + d + e. remove the filter holder frame and the metal grease filter (and the carbon filter).

Refit the parts in reverse order.

Replacing bulbs

Disconnect the appliance from the power supply.

Warning! Make sure lamps are cold before touching them.

Replacing the middle lamp: only use halogen lamps max. 40W 40° D25 GU10.

Removing the lamp:

remove the filter holder frame, turn anti-clockwise by 1/4 turn and remove.

To fit the lamp:

insert the lamp in the special seat so that its contacts enter the seats on the lamp holder, and twist 1/4 turn (approx.) clockwise.

Replacing the side lamps

Remove the lampholder by unscrewing the three screws that fix it to the hood (Fig. 12).

Warning! While removing its fixing screws, the lampholder could drop and smash or cause damage, so hold it with one hand while removing it.

Unscrew the burnt-out lamp and replace with with an olive-shaped, 40W max (E14).

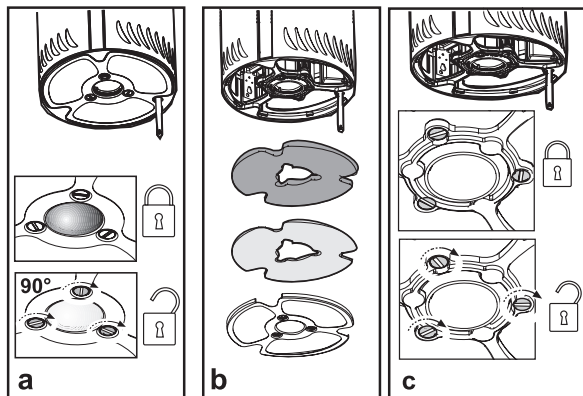
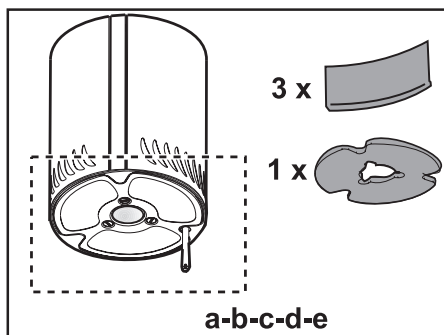

Fig. 11

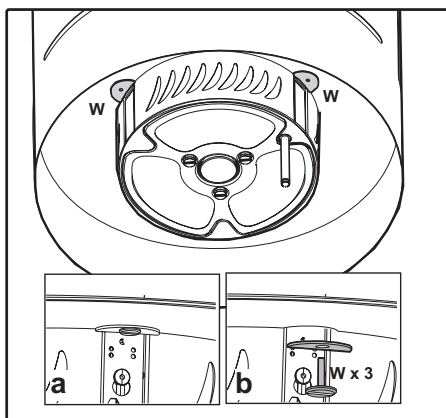
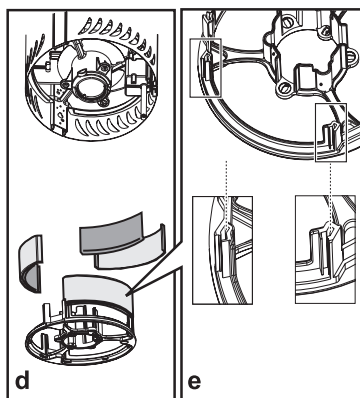

Fig. 12

SAFEGUARDING THE ENVIRONMENT

1. Packing

The packing materials are 100% recyclable and are marked with the recycling symbol ♻️. Comply with local regulations for disposal. The packing materials (plastic bags, polystyrene parts, etc.) are a potential source of danger and must be kept out of the reach of children.

2. Product

This appliance is marked in compliance with European Directive 2002/96/EC on Waste Electrical and Electronic Equipment (WEEE). By ensuring that this appliance is correctly scrapped, the user can help prevent potentially harmful consequences for the environment and the health of people.

The symbol  on the product or the accompanying documentation indicates that it should not be treated as domestic waste but must be taken to a suitable collection centre for the recycling of electrical and electronic equipment.

Disposal must be carried out in compliance with local regulations on waste disposal.

For further information on the treatment, recovery and recycling of this product, contact the competent local office, the household waste collection service or the shop where you purchased the appliance.



PRECAUTIONS AND GENERAL RECOMMENDATIONS

IMPORTANT!

- **The appliance is not intended for use by children or people with limited physical, sensory or mental abilities or without experience and knowledge of it, unless they are supervised or instructed in its use by a person responsible for their safety.**

-  Children must be supervised so that they do not play with the appliance.
1. Do not connect the appliance to the mains power supply until installation has been completed. Always disconnect the hood before any cleaning or maintenance, by unplugging it or turning off the main switch in the home.
 2. Do not “flambe” food under the hood. Naked flames could cause a fire.
 3. Do not leave pans unattended when frying, since the cooking oil could catch fire.
 4. Regular cleaning and maintenance is essential for correct hood operation and good performance. Regularly clean all deposits from dirty surfaces. Regularly remove and clean or change the filter. Do not use flammable materials to duct the extracted air.
 5. If the hood is used together with other appliances operating on gas or other fuels, the negative pressure in the room must not exceed 4Pa (4 x 10⁻⁵ bar). Therefore, make sure the room is adequately ventilated.
 6. The air extracted by the hood must not be removed through the flue of the heating system or other appliances that use gas or other fuels.
 7. The room must be adequately ventilated when the hood is used together with appliances operating on gas or other fuels.
 8. Make sure lamps are cold before touching them.
 9. The discharge air must not be ducted in a flue used for removing fumes produced by appliances operating on gas or other fuels, but must have a separate outlet.
All national regulations on air discharge must be observed.
 10. The hood is not a shelf, therefore do not overload or place objects on it.
 11. Do not use or leave the hood without its lamps correctly installed - risk of electric shock.

Note: Always wear work gloves for all installation and maintenance operations.

Electrical connection

The mains power supply must match the voltage given on the dataplate located inside the hood. If provided with a plug, connect the hood to a socket complying with current regulations and located in an accessible area. If it does not have a plug (direct connection to the power supply) or if the socket is not in an accessible place, fit a suitable double-pole switch that ensures complete disconnection from the power supply in category III overvoltage conditions, complying with the installation rules.

IMPORTANT: Before reconnecting the hood circuit to the power supply and checking correct operation, always make sure the power cable is correctly fitted and that it was NOT crushed in its housing during installation.

Cleaning the hood

Warning! Failure to remove oil/grease (at least once a month) could result in fire.

Use a soft cloth with a neutral detergent. Never use abrasive substances or alcohol.

Before using the hood

To ensure best use of your hood, please read these instructions carefully and keep them for future reference.

The packing materials (plastic bags, polystyrene parts, etc.) are a potential source of danger and must be kept out of the reach of children.

Make sure the hood was not damaged during transport.

Declaration of conformity

This product has been designed, manufactured and put on the market in conformity with the following:

- safety objectives of "Low Voltage" Directive 73/23/EEC
- protection requirements of "EMC" Directive 89/336/EEC amended by Directive 93/68/EEC.

Troubleshooting guide

The hood does not work:

- Is the plug properly inserted in the power socket?
- Is there a power failure?

The hood is not extracting enough:

- Is the right speed selected?
- Do the filters need cleaning or changing?
- Are the air outlets blocked?

The light does not work:

- Does the lamp need replacing?
- Is the lamp correctly fitted?

AFTER-SALES SERVICE

Before calling the After-Sales Service

1. See if you can eliminate the problem on your own (refer to "Troubleshooting guide").
2. Switch the hood off and then on again to check if the problem has been eliminated.
3. If the problem persists, contact the After-Sales Service.

Specify:

- the type of fault,
- the product model given on the dataplate inside the hood, visible on removing the grease filters.
- your full address,
- your telephone number and area code.
- the Service code (the number under the word SERVICE on the dataplate inside the hood, behind the grease filter).

If any repairs are necessary, contact an authorised Service Centre (to ensure the use of original spare parts and correct repair). Failure to comply with these instructions can compromise the safety and quality of the product.

SERVICE



0000 000 00000